

# GCTB175

## Garden Gate Closer

The GCTB175 Garden Gate Closer is an inexpensive gate closer for lightweight gates or doors which provides hydraulically controlled closing speed and final latching speed adjustments. This closer was designed for installation to garden gates and lightweight doors (non fire doors) where the \* gate post or door frame is flush with the gate or door and where the hinge point is at the corner of the gate post or door frame (like a typical internal house door with butt hinges).

If you are a fencing contractor looking to provide your customer with a compact gate closer solution for their new gate, the GCTB175 Garden Gate Closer would be a natural choice. Other common OEM applications are with machine guarding (cage doors), kennels, shed doors, shutters and fly screens and the like.

The Garden Gate Closer's popularity is driven by two things, quick and simple installation and value for money. It's one of the simplest gate closer installations you will find.

Installs on top, middle or bottom of either right or left hand of gate  
Mounts on opening side of gate, pushing it closed



### Key features:

Simple to install

Adjustable closing speed

Adjustable final latch speed

Suitable for timber or metal gates & doors

90 degree opening angle

Gate weight up to 50 kg (max.)

Gate width up to 1.0 m (max.)

Gate height up to 1.8 m (max.)

Black powder coated steel housing

**\*To retain product warranty & restrict gate opening angle further than the 90 degree limit, a gate stop must be installed**

Garden Gate Closer - black  
**GCTB175**

**\* CAUTION** - The Garden Gate Closers are only suitable for installation where the gate post or door frame are flush with the gate or door and the hinge point is on the corner of the post or door (see installation instructions on next page).

## Suitable For 'T' and Butt Hinges Where Gate and Post Are Flush

This gate closer is specifically designed for installing to gates that have two types of hinges, 'T' hinges and butt hinges. Examples of these hinges are shown in the drawings below.

Do **NOT** fit this gate closer to any gate that does not have suitable types of hinges or if the size, weight and dimensions are outside the range shown in the instructions.

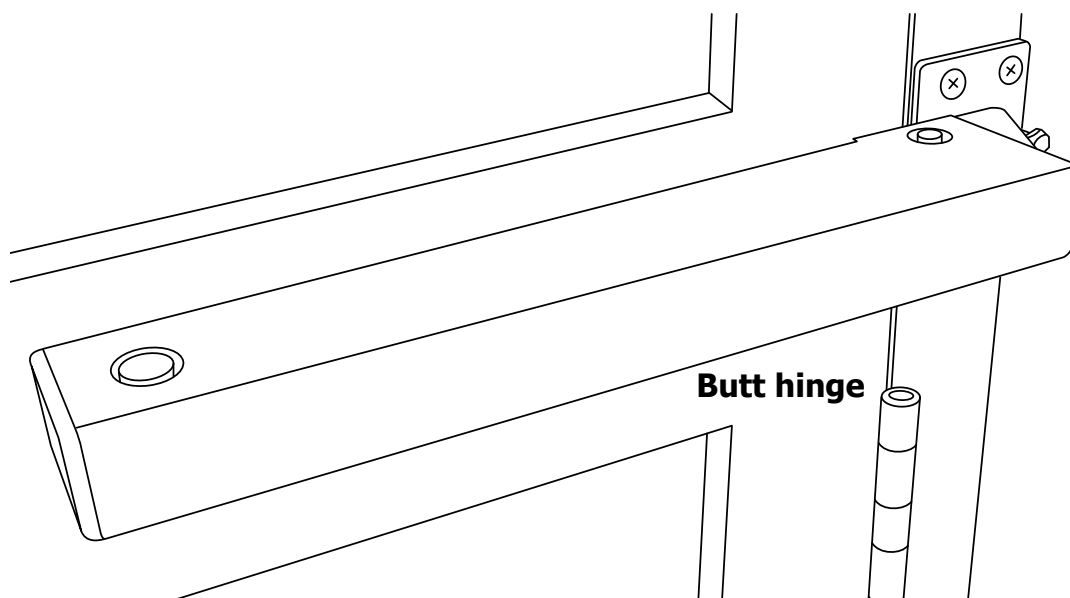
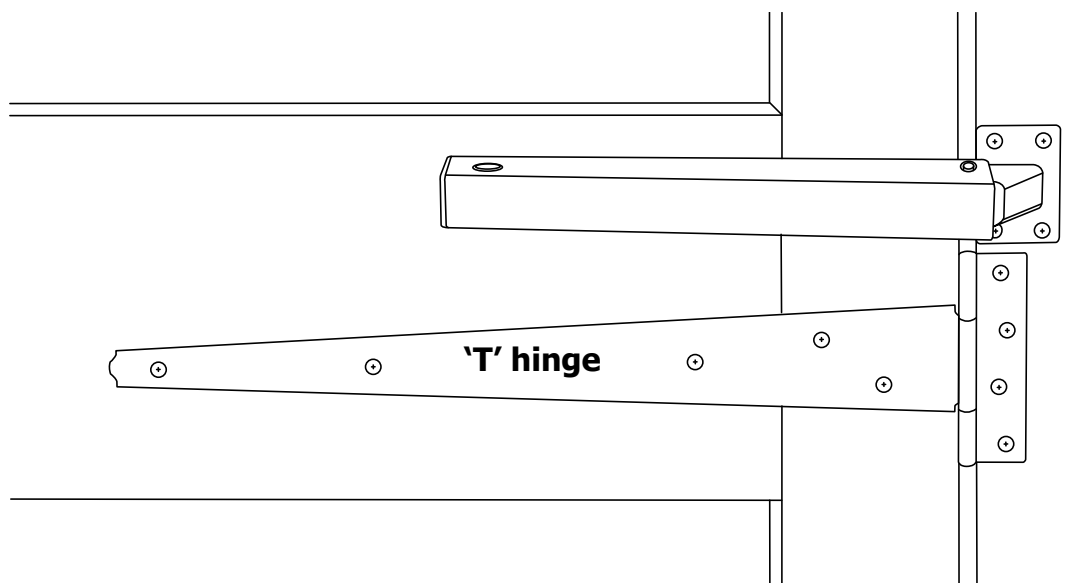
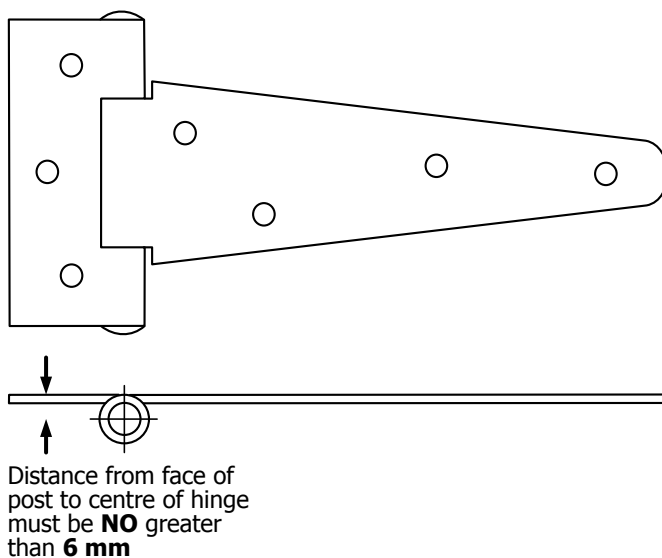

# INSTALLATION INSTRUCTIONS FOR GATE CLOSER

Maximum Gate Weight-50kg

Maximum Gate Width-1000mm

- The pivot point of the closer must be in line with the pivot point of the hinges. It may be necessary to fabricate a bracket to allow the closer to be fitted correctly.
- The closer can be fitted to the top, middle or bottom of the gate on the "pull" side only.
- The gate face must be flush with the gatepost face and hinged as close as possible to the post.
- The gate must swing freely on the hinges prior to fixing the closer and the hinges regularly greased.
- The guide roller must be fitted and it may be necessary to fabricate a bracket to receive the roller.
- The gate must not be allowed to open more than 90° and a ground stop must be fitted if required.
- The holding pin (see fig. 4) must not be removed until the closer is fitted.

1. From the centre pivot line of the hinges, measure 222mm (8-3/4") - see positioning mark and secure guide roller to gate

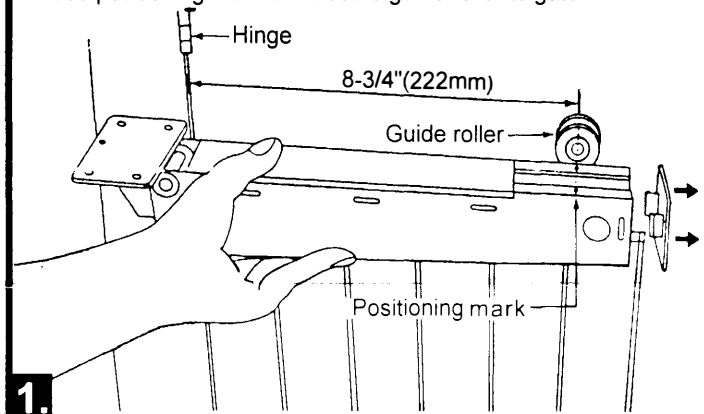

2. Pull off the end cover, slide the closer groove onto the guide roller, then push back the end cover.

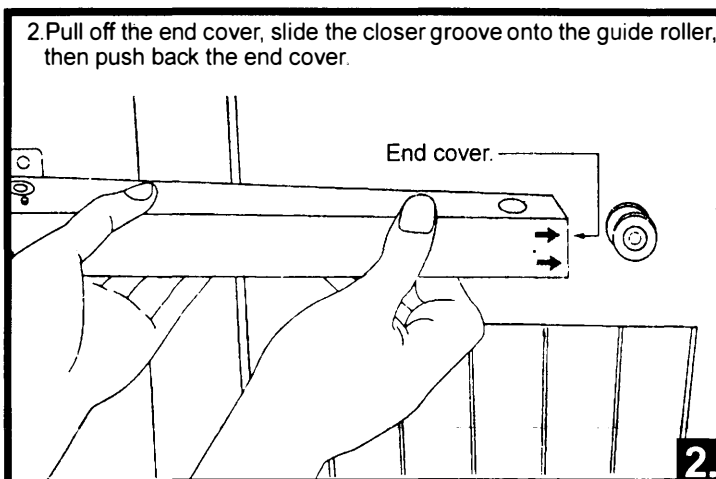

3. Secure the bracket on the column

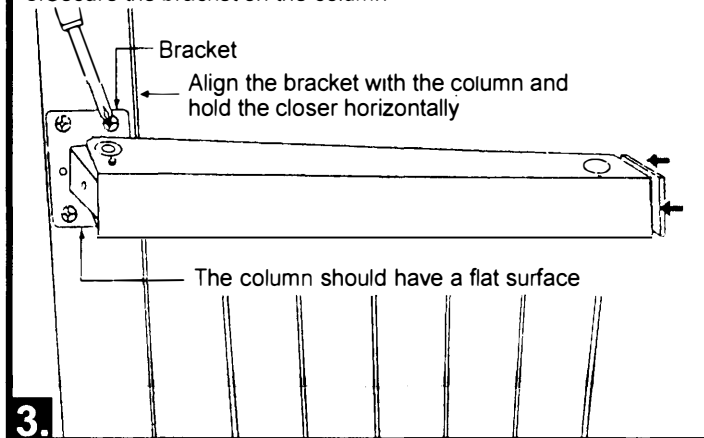

4. Open the door slightly to let the holding pin drop off from the closer.

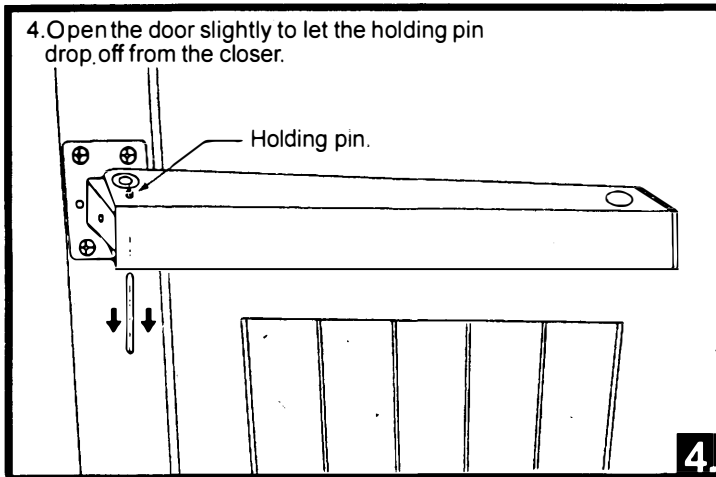

5. Holding the door at about 45° open, use a screwdriver and turn 1/4 circle anti-clockwise or clockwise at a time for faster or slower closing speed as desired.

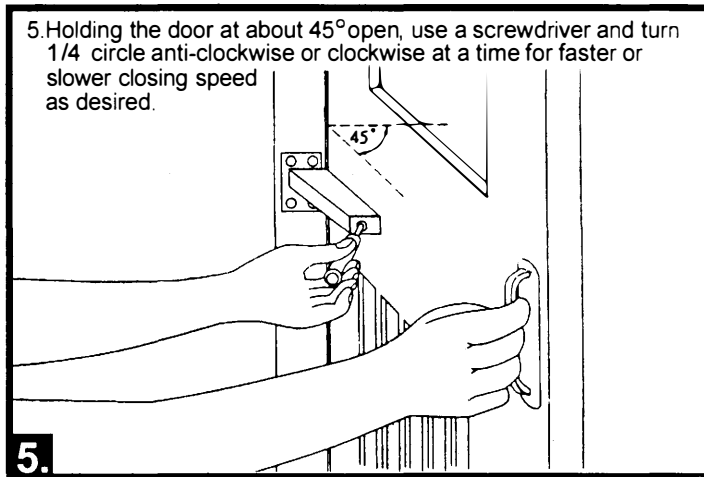

6. Leaving the door at closed position, adjust your desired latching speed by the same way as above 5.

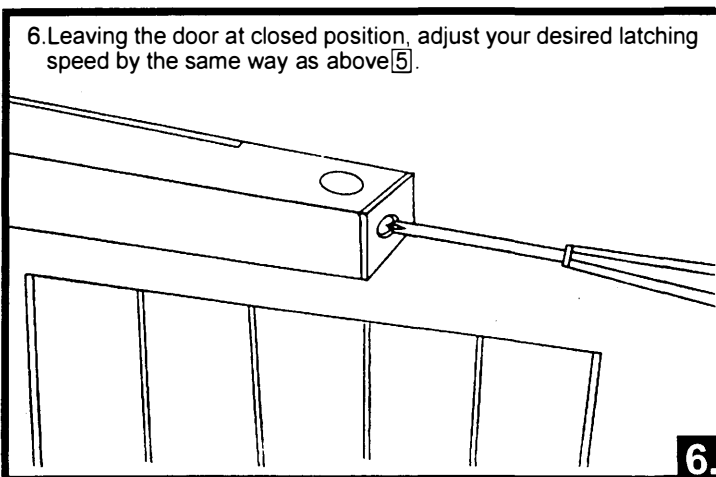

7. To have the door operate with a "Hold open" mode, simply remove the screw from the hole "A" and attach it to hole "B". Do not attempt to force the closer beyond the screw. Doing so may damage the closer.

